

vtech[®]
Baby

Parent's Guide

Drive & Discover Baby Keys



91-003479-001 (UK)

VTech understands that a child's needs and abilities change as they grow and with that in mind we develop our toys to teach and entertain at just the right level...

vtech Baby

Toys that will stimulate their interest in different textures, sounds and colours

I am...

...responding to colours, sounds and textures

...understanding cause and effect

...learning to touch, reach, grasp, sit-up, crawl and toddle

Birth-36 months



Pre-School

Interactive toys to develop their imagination and encourage language development

I want...

...to get ready for school by starting to learn the alphabet and counting

...my learning to be as fun, easy and exciting as can be

...to show my creativity with drawing and music so my whole brain develops

3-6 years



Electronic Learning Computers

Cool, aspirational and inspiring computers for curriculum related learning

I need...

...challenging activities that can keep pace with my growing mind

...intelligent technology that adapts to my level of learning

...National Curriculum based content to support what I'm learning at school

4-10 years



To learn more about this and other VTech® products, visit www.vtech.co.uk

INTRODUCTION

Thank you for purchasing the **VTech® Drive & Discover Baby Keys**. Press the three colourful buttons or shake the keys to hear songs, phrases, music and cute sound effects. Dangling keys have rattle beads, a baby-safe mirror, a teether and rollers for even more fun!

Flashing Light

Motion
Sensor

Colourful
Roller

Car Key

Colourful
Buttons

Off/Low/High
Volume Switch

House Key

Bear Key

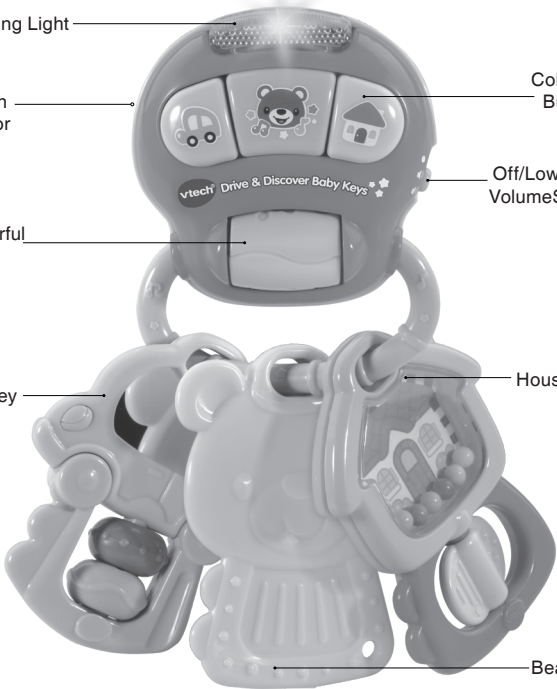

INCLUDED IN THIS PACKAGE

- One Drive & Discover Baby Keys
- One parent's guide

WARNING: All packing materials such as tape, plastic sheets, packaging locks, removable tags, cable ties and packaging screws are not part of this toy, and should be discarded for your child's safety.

NOTE: Please keep user's manual as it contains important information.

Unlock the packaging locks:

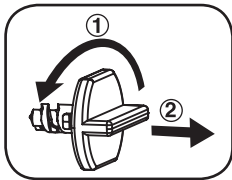

- ① Turn the packaging lock anticlockwise several times.
- ② Pull out and discard the packaging lock.

GETTING STARTED

BATTERY INSTALLATION

1. Make sure the unit is turned **OFF**.
2. Locate the battery cover on the bottom of the unit.
3. Use a screwdriver to loosen the screw.
4. Install 3 new LR44 button cell batteries following the diagram inside the battery box. (The use of new alkaline batteries is recommended for maximum performance.)
5. Replace the battery cover and tighten the screw to secure.

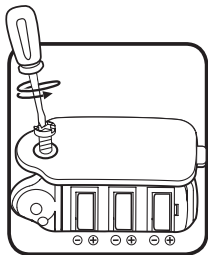

BATTERY NOTICE

- Use new alkaline batteries or fully charged NI-MH (Nickel Metal-hydride)
- Use only batteries of the same or equivalent type as recommended.
- Do not mix different types of batteries: alkaline, standard (carbon-zinc) or rechargeable, or new and used batteries.
- Do not use damaged batteries.
- Insert batteries with the correct polarity.
- Do not short-circuit the battery terminals.
- Remove exhausted batteries from the toy.
- Remove batteries during long periods of non-use.
- Do not dispose of batteries in fire.
- Do not charge non-rechargeable batteries.
- Remove rechargeable batteries from the toy before charging (if removable).
- Rechargeable batteries are only to be charged under adult supervision.

Disposal of batteries and product



The crossed-out wheellie bin symbols on products and batteries, or on their respective packaging, indicates they must not be disposed of in domestic waste as they contain substances that can be damaging to the environment and human health.



The chemical symbols Hg, Cd or Pb, where marked, indicate that the battery contains more than the specified value of mercury (Hg), cadmium (Cd) or lead (Pb) set out in Battery Directive (2006/66/EC).

The solid bar indicates that the product was placed on the market after 13th August, 2005.

Help protect the environment by disposing of your product or batteries responsibly.



For more information, please visit:

www.recycle-more.co.uk

www.recyclenow.com

PRODUCT FEATURES

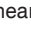
1. Off/Low/High Volume Switch

To turn the unit **ON**, slide the **Off/Low/High Volume Switch** to the **High Volume** () or **Low Volume** () position. You will hear a song and a variety of playful phrases. To turn the unit **OFF**, slide the **Off/Low/High Volume Switch** to the **Off** () position.



2. Automatic Shut Off

To preserve battery life, the **Drive & Discover Baby Keys** will automatically power down after approximately 30 seconds without input. The unit can be turned on again by pressing one of the three buttons.

NOTE: If the unit powers down while playing, we suggest changing the batteries.

ACTIVITIES

1. Colourful Buttons

Press each of the three **Colourful Buttons** to hear playful songs, phrases and melodies. Press the car button to hear car sound effects, the bear button to hear cute and playful bear growls and the home button to hear keys jangling and the sound of a door opening.



When a melody is playing, shake the keys to hear fun sounds play over the melody. When pressing and holding two of the colourful buttons at the same time, additional fun sound responses will be played. The light will flash with the sounds.

2. Motion Sensor

Shake the keys to activate the **Motion Sensor**. You will hear a variety of playful sounds and phrases. The light will flash with the sounds.



3. Colourful Roller

Spin the **Colourful Roller** to hear the beads bouncing around inside the barrel and to encourage development of fine motor skills.



4. House Key

Shake the **House Key** to hear the colourful beads rattle and introduce cause and effect. Spin the blue disc to promote fine motor skills.



5. Car Key

The **Car Key** features a baby-safe mirror that helps develop self-awareness and self-discovery. The textured rollers promote sensory development and fine motor skills.



6. Bear Key

The soft **Bear Key** soothes your little one's sore gums and the textured design promotes sensory development.



SONG LYRICS

SONG 1

The sun is out,
The sky is blue.
Grab your keys and take me with you.

SONG 2

The wheels on the car go round and round,
Turn the keys,
Start the car.
The wheels on the car go round and round,
All through the town.

SONG 3

Home sweet home.
Use our key.
Open the door,
To see who's waiting for me.

MELODY LIST

1. Home Sweet Home
2. Pease Porridge Hot
3. Hot Cross Buns
4. The Green Grass Grew All Around
5. Shoo Fly, Don't Bother Me
6. The Teddy Bears' Picnic
7. Twinkle, Twinkle, Little Star
8. The Bear Went Over the Mountain
9. Skip to My Lou
10. Animal Fair
11. She'll be Coming 'Round the Mountain
12. Jack and Jill
13. Take Me Out to the Ball Game
14. Polly Wolly Doodle
15. BINGO

CARE & MAINTENANCE

1. Keep the unit clean by wiping it with a slightly damp cloth.
2. Keep the unit out of direct sunlight and away from any direct heat source.
3. Remove the batteries when the unit will not be in use for an extended period of time.
4. Do not drop the unit on hard surfaces and do not expose the unit to moisture or water.

TROUBLESHOOTING

If for some reason the unit stops working or malfunctions, please follow these steps:

1. Please turn the unit **OFF**.
2. Interrupt the power supply by removing the batteries.
3. Let the unit sit for a few minutes, then replace the batteries.
4. Turn the unit **ON**. The unit should now be ready to play again.
5. If the unit still does not work, replace with an entire set of new batteries.

If the problem persists, please call our Consumer Services Department on 01235 546810 (from UK) or +44 1235 546810 (outside UK) and a service representative will be happy to help you.

IMPORTANT NOTE:

Creating and developing VTech® products is accompanied by a responsibility that we at VTech® take very seriously. We make every effort to ensure the accuracy of the information which forms the value of our products. However, errors sometimes can occur. It is important for you to know that we stand behind our products and encourage you to call our Consumer Services Department on 01235 546810 (from UK) or +44 1235 546810 (outside UK) with any problems and/or suggestions that you might have. A service representative will be happy to help you.

**CLASS 1
LED PRODUCT**



PRODUCT REGISTRATION

Visit www.vtech.co.uk/clubvtech/login
to register your VTech product

By joining the VTech Club you can also enter competitions, find out about news and events, seek expert advice for parents and let your kids play fun learning games and activities.



PRODUCT WARRANTY

Thank you for choosing this quality product from VTech. We hope it will bring many hours of entertainment, imaginative play and learning.

1. The product detailed above is covered by a one year warranty from the date of purchase, against any defects in materials or workmanship.
2. The product may be returned to the place of purchase. Alternatively the product can be returned to VTech Electronics Europe plc (see address below), with proof of purchase, without proof of purchase no replacement will be provided.
3. VTech Electronics Europe plc will examine the product and if it is found to be defective due to faulty materials or workmanship, will replace the product at their discretion.
4. If the product covered by this warranty is damaged due to misuse, modification or unauthorised repair, or because of faulty batteries, battery discharge or incorrect electrical connections, then this warranty becomes void.
5. This warranty is personal to the original purchaser and is not transferable.
6. Breakages to the LCD screen are not covered by the warranty.
7. Returns to VTech Electronics Europe plc should include a cheque or postal order for £1.50 towards the cost of return postage and packaging.
8. Products returned to VTech Electronics Europe plc, should be addressed as follows and packed carefully to avoid damage in transit (Please do not include batteries or adaptor). Please include details of the fault together with your name and address.
9. To keep an online record of your warranty, please register your product online at www.vtech.co.uk/warranty

Vtech Electronics EU PLC, c/o XPO Logistics, Warehouse 350, Cat & Fiddle Lane, West Hallam, DE7 6HE

THIS WARRANTY IS OFFERED AS AN EXTRA BENEFIT AND DOES NOT AFFECT CONSUMERS' STATUTORY RIGHTS.

This warranty is valid for the UK and Eire only. For products purchased outside the UK and Eire, please contact your local distributor or place of purchase.



**Visit our website for more
information about our products,
downloads, resources and more.**

www.vtech.co.uk



TM & © 2018 VTech Holdings Limited.
All rights reserved
Printed in China
91-003479-001 UK